

## *it's all about the blues*

If you love a color, run with it! In this cozy coastal kitchen, moody hues add the wow—appearing as both easy background and bright accents.

BY JODY GARLOCK | PHOTOS MICHAEL PARTENIO  
PRODUCED BY STACY KUNSTEL

Stone Blue No. 86  
Farrow & Ball

Blue cabinets set a casual mood in this Massachusetts kitchen. “We wanted it to be playful,” designer Elizabeth Swartz says. “The room gets fabulous natural light, so we could be bold with the cabinets.”



Soft whites, rich woods (including rustic-looking beams), and dark bronze accents warm the cool blues. Wood flooring shifts to cork in the kitchen for softness.

**SO HANDY**  
A beverage cooler brings function to a dead-space corner. Sips are easy to grab from the living room.

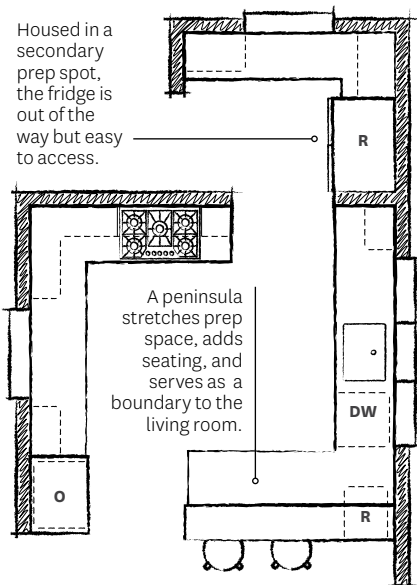

## SEEING IS BELIEVING

for designer Elizabeth Swartz. She's been known to fashion crude chandeliers out of tuna cans and clothes hangers to help homeowners visualize the scale of light fixtures. She has mocked up peninsulas from card tables topped with milk crates and foam core to show how the real deal would alter traffic flow. But this kitchen didn't require any visualization tricks; the homeowner was sold on nearly everything that Swartz suggested, including color. "Beige is not one of my go-to basics," says the designer, who heads her namesake Boston firm, Elizabeth Swartz Interiors. "I'm big on color."

In this case, she was big on blue, the homeowner's favorite color that nods to her Scandinavian heritage as well as the nearby ocean. Swartz ran with blues—some leaning gray; others, green—on cabinets, stone countertops, and the glass tile backsplash. She then shifted to more noticeably different shades with accessories, such as cobalt art glass pendants and turquoise sconces. "Variety is key," Swartz says. "I like to bring in different shades and textures for interest. If you're not afraid of color, I say go for it. Choose what you like and be confident."

**STEPPED UP**

A granite ledge takes the place of a wood windowsill for continuity with the countertop.



**Other blues to try**

These cool hues—all good for cabinets—happily pair with stainless steel and brushed nickel.

*Sailor's Sea Blue*  
2063-40  
Benjamin Moore

*Mystery*  
MQ5-51  
Behr

*Atmospheric*  
SW6505  
Sherwin-Williams



**CONSIDER THE LIGHTING** when you're choosing a color. Even the type of bulbs you choose will change the look."

Elizabeth Swartz, designer

"We grabbed space wherever we could," Swartz says. A porch converted into a pantry houses the refrigerator, *left*. A transom window added above the doorway draws light into the kitchen.

Shelves built into the side of a cabinet, *opposite right*, offer easy access to cookbooks; a false door fronts the cabinet. The convenience trumped the lost hidden storage, Swartz says. ■



**BEST BETS FOR BLUES**

Blue is beautiful in the kitchen. Watch these tips on how to use a little or a lot. [BHG.com/AddBlue](http://BHG.com/AddBlue)